

# Measuring Area

## Compound Shapes

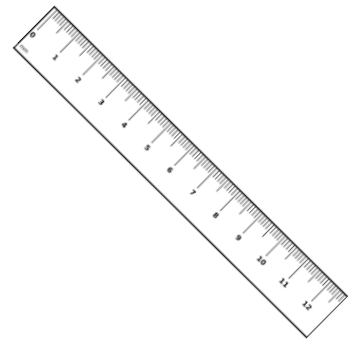

**Check before  
printing:**

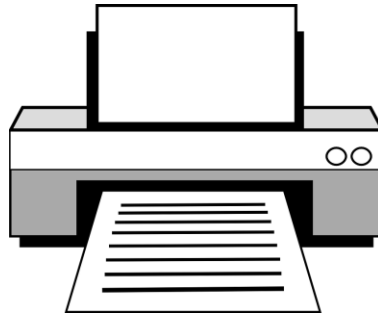

The default setting of many printers is to scale the page to a slightly smaller size (eg. 96%). For the measurements to print accurately on this resource, it must to be printed at 100% size.

You will find the option to check/change the scale in the printer dialogue box under more settings, or printer properties. Select 'actual size', or '100%'.

# Measuring Area

## Compound Shapes

Measure and record the dimensions of each shape.  
Calculate the area.

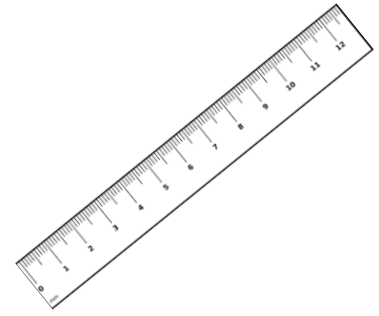

area = \_\_\_\_\_

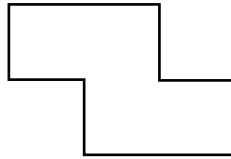

area = \_\_\_\_\_

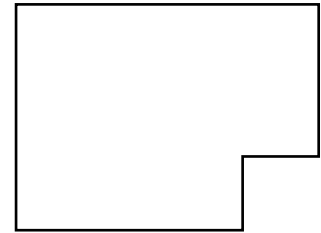

area = \_\_\_\_\_

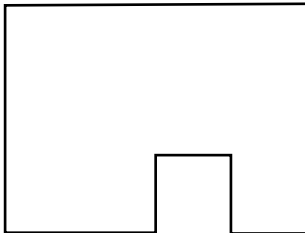

area = \_\_\_\_\_

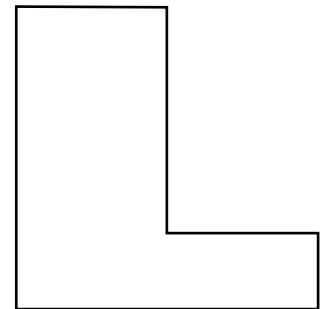

area = \_\_\_\_\_

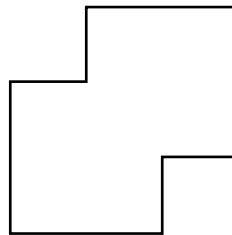

area = \_\_\_\_\_

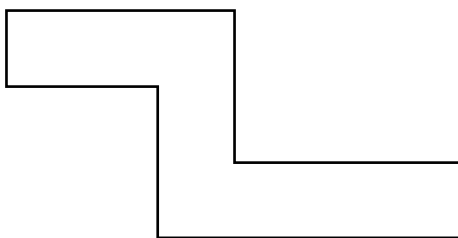

area = \_\_\_\_\_

area = \_\_\_\_\_

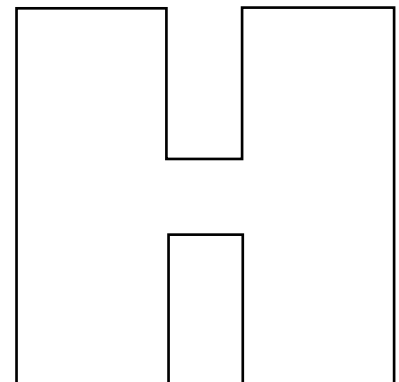

# Measuring Area **Answers**

## Compound Shapes

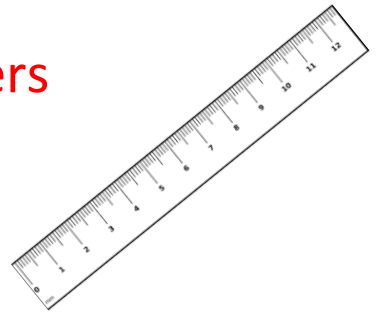

Measure and record the dimensions of each shape.  
Calculate the area.



area = **7cm<sup>2</sup>**

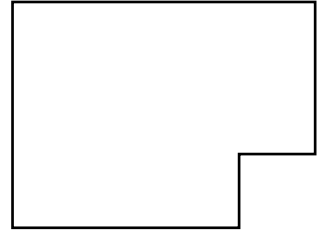

area = **11cm<sup>2</sup>**

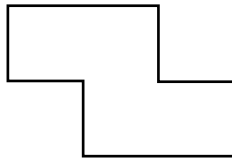

area = **4cm<sup>2</sup>**

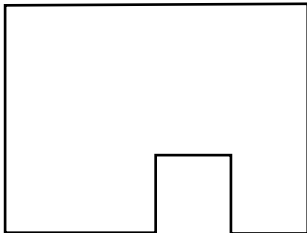

area = **11cm<sup>2</sup>**

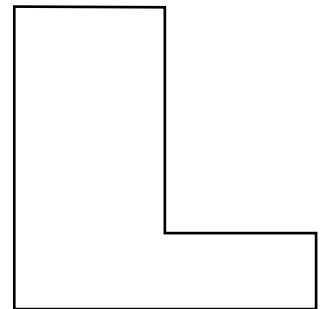

area = **10cm<sup>2</sup>**

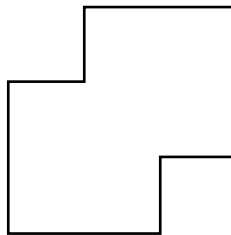

area = **7cm<sup>2</sup>**

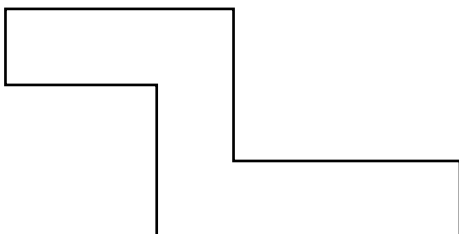

area = **8cm<sup>2</sup>**

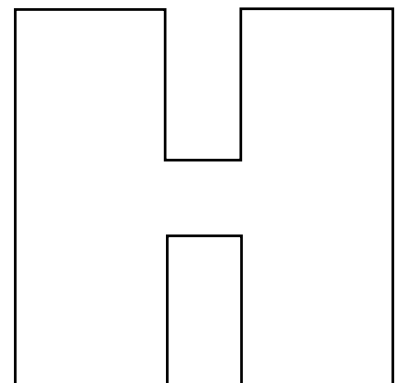

area = **21cm<sup>2</sup>**